

TYPICAL TRANSVERSE SECTION A-B-C UNITS
 SCALE: 1/4" = 1'-0"
 SECTION A-B-C-C

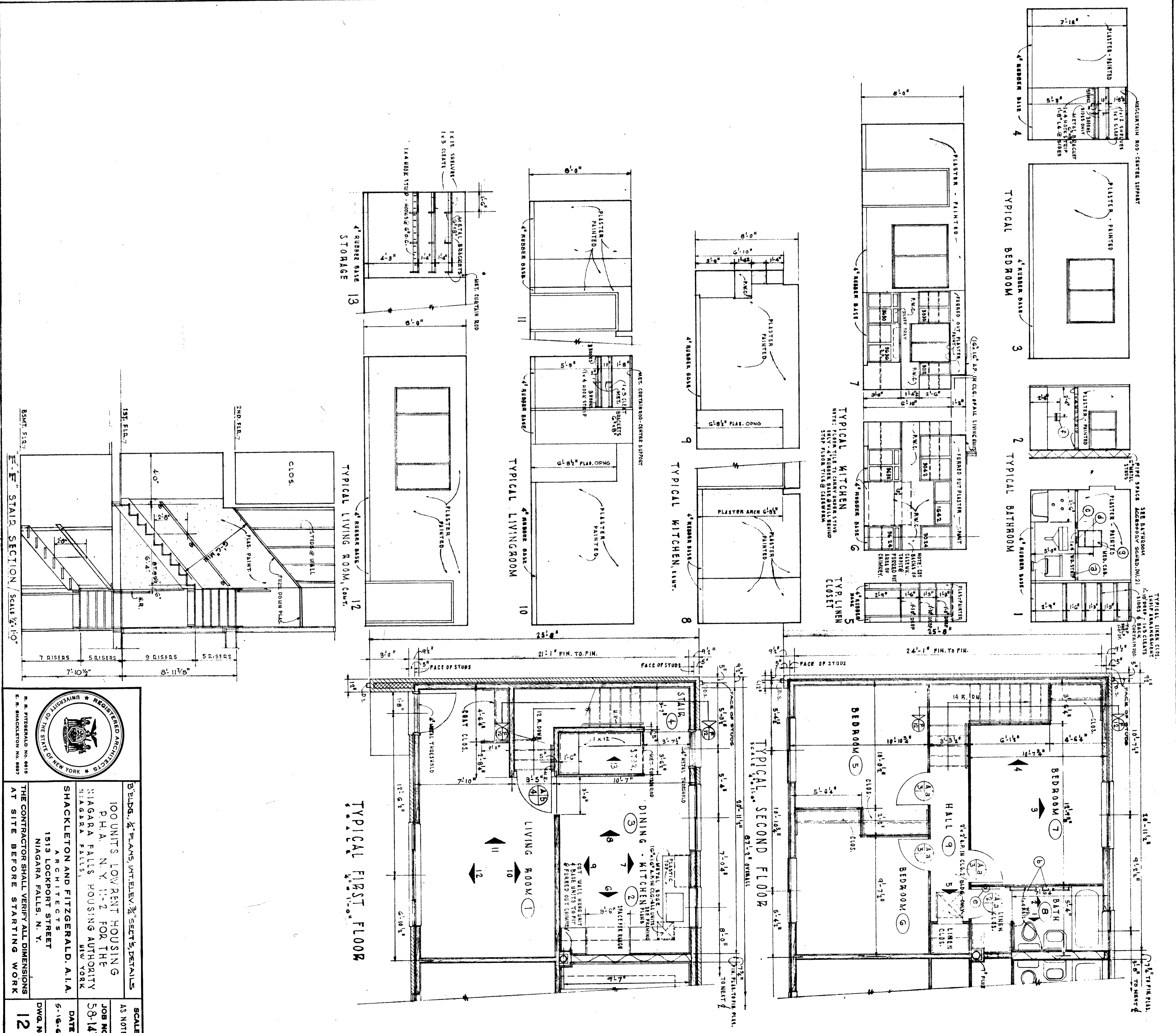

TYPICAL SECOND FLOOR
 SCALE: 1/4" = 1'-0"

REGISTERED ARCHITECT
 STATE OF NEW YORK

SHACKLETON AND FITZGERALD, A.I.A.
 ARCHITECTS
 1913 LOCKPORT STREET
 NIAGARA FALLS, N. Y.

100 UNITS LOW RENT HOUSING
 P.H.A. N.Y. N-2 FOR THE
 NIAGARA FALLS HOUSING AUTHORITY
 NIAGARA FALLS

DATE 5-18-60
DWG. NO. 12

SCALE AS NOTED
JOB NO. 58-147
THE CONTRACTOR SHALL VERIFY ALL DIMENSIONS AT SITE BEFORE STARTING WORK